

Accessories



Knobs









K-130 Round rose

Round rose with knob K-130. Completely rivetted to base rose. Complete with cover rose and pre-mounted sleeve nuts (M5 x 30 mm).

M8 / M12 thread for a spindle for a knob / lever set

Please order the fixing material separately.

 **EN 1906** **F**

						
ER	691570.46	691500.46	691440.46			
Al	691570.30	691500.30	691440.30	691501.30	691441.30	







K-165 Round rose

Round rose with knob K-165. Completely rivetted to base rose. Complete with cover rose and pre-mounted sleeve nuts (M5 x 30 mm).

M12 thread for a spindle for a knob / lever set

Please order the fixing material separately.

 **EN 1906** **F**

				
ER	691571.46	692200.46	692300.46	







K-135 Round rose

Round rose OKL-fire protection with knob K-135. Completely rivetted to base rose (ER), complete with cover rose (stainless steel satin) and pre-mounted sleeve nuts (M5 x 30 mm). **M12 thread for a spindle for a knob/lever set**

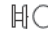
Please order the fixing material separately.

 **OGL** **EN 1906** **F**

				
ER	694000.46	694500.46	694550.46	
ER	693000.46	693500.46	693550.46	M12



K-165 Oval rose

Oval rose with knob K-165. Completely rivetted to base rose. Complete with cover rose. **M12 thread for a spindle for a knob / lever set**

The execution aluminum is polished.

Please order the fixing material separately.

 **F**

	Execution		
ER	fixed	101783004600010	
Al	F1p fixed	101783004600010.3a	
ER	Fixable bearing	101782244600010	
Al	F1p Fixable bearing	101782244600010.3a	

Security plates / -roses

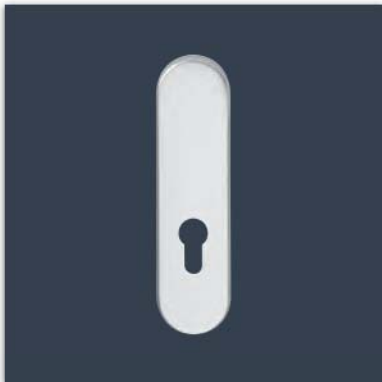

Short plate

- Cover plates with base construction
- Standard colour nylon: black

EN 1906 EN 179

ER	326198.46	326196.46		
AI	327198.30	327196.30	327180.30	327181.30
Ku	324188.02	333720.02	325180.02	325194.02



Roses for OGL

- Cover plates with base construction
- Standard colour nylon: black

EN 1906 EN 179

ER	366070.46	366075.46	176605.46	176606.46
AI	367076.30	367075.30	177605.30	177606.30
Ku	354810	354811.02	361100	361135



Set of security roses with PZ hole

Material: Stainless steel satin
Consists of:

- Security rose with positioning studs (PZ)
- Steel base rose with cover rose (PZ)
- Fixing material
- Please specify door thickness
- Other door thicknesses on request

Standard door thickness 38 - 45 mm (WR) / 40-66 mm

Execution	11 mm	14 mm
Article number	214500.46	214510.46

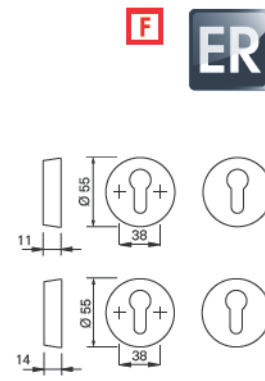

Set of security roses with pull-off protection (ZA)

Material: Stainless steel satin
Consists of:

- Security rose with positioning stud (ZA), steel base rose with cover rose (PZ)
- Fixing material
- Pull-off protection (ZA) cylinder overlap 7 - 15 mm
- Please specify door thickness
- Other door thicknesses on request

Standard door thickness 38 - 45 mm (WR) / 40-66 mm

Execution	14 mm
Article number	214515.46

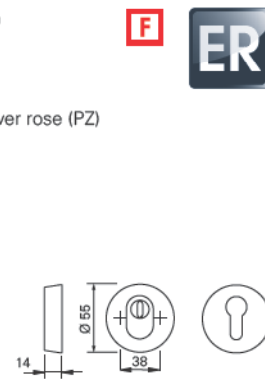

Security roses

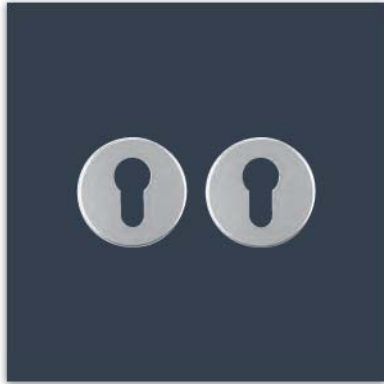

Set of security roses with PZ hole

F
AI

Material: Aluminium F1

Consists of:

- Security rose with positioning studs (PZ), steel base rose with cover rose (PZ)
- Fixing material
- Door thickness 38 - 45 mm
- Other door thicknesses on request

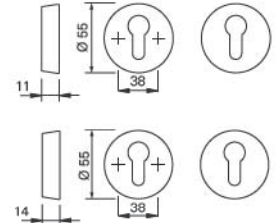
 Standard door thickness 40 - 66 mm **F**

Execution	11 mm	14 mm
Article number	214500.30	214510.30

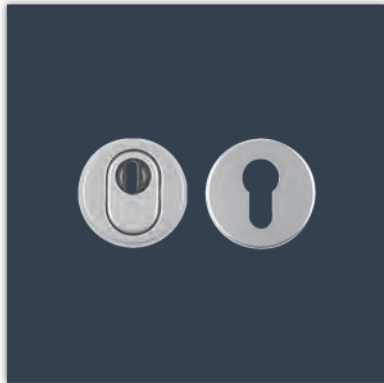

Set of security roses with pull-off protection (ZA)

F
AI

Material: Aluminium F1

Consists of:

- Security rose with positioning stud (ZA), steel base rose with cover rose (PZ)
- Fixing material
- Pull-off protection (ZA) cylinder overlap 7 - 15 mm
- Door thickness 38 - 45 mm
- Other door thicknesses on request

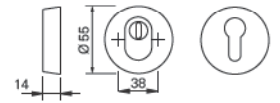
 Standard door thickness 40 - 66 mm **F**

Execution	14 mm
Article number	214515.30

Door stop



Door stop BS 44

Material: Stainless steel 1.4301
Finish: Satinized / including fixing material



Execution	Door stop BS 44
Article number	257001.46

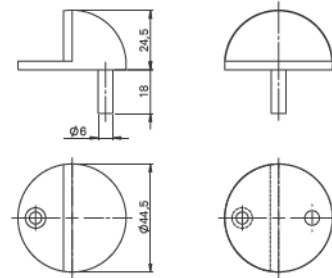

Door stop BS 45

Material: Stainless steel 1.4301
Finish: Satinized / including fixing material



Execution	Door stop BS 45
Article number	257002.46

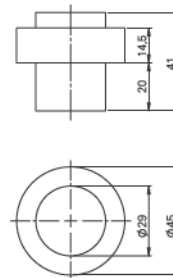

Door stop BS 65

Material: Stainless steel 1.4301.
Finish: Satinized / including fixing material



Execution	Door stop BS 65	Base plate for BS 65 13 mm high (black lacquered)*
Article number	257009.46	25701214

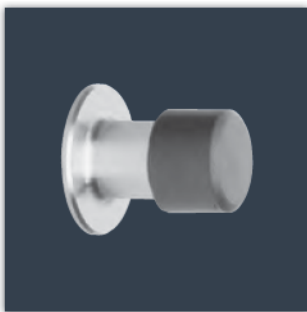
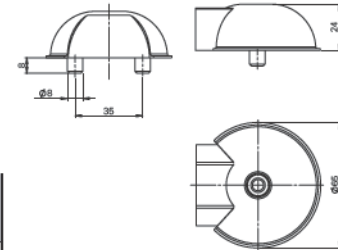

Door stop for walls WS 46

Material: Stainless steel 1.4301
Finish: Satinized / including fixing material



Execution	Door stop for walls WS 46
Article number	257008.46

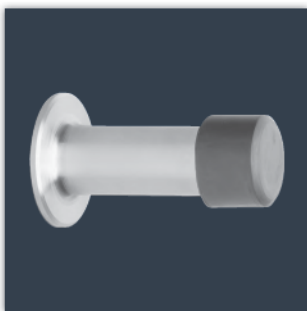
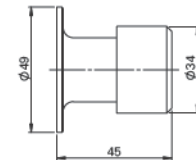

Door stop for walls WS 76

Material: Stainless steel 1.4301.
Finish: Satinized / including fixing material



Execution	Door stop for walls WS 76
Article number	257007.46

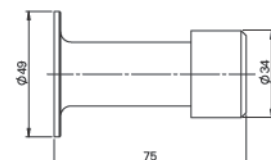

Push-pull handles

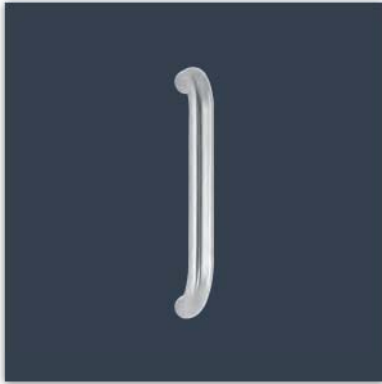

S-110 Push-pull handle straight

Handle diameter 32 mm. Distance between centres 300 mm. Simple and fast mounting. Single-sided or double-sided fastening possible.

Note: Further centre distances on request.
The accessory for the single-sided fastening has to be ordered separately.



Execution	Single-sided without fixing material	Double-sided incl. fixing material
Article number	255611.46	255621.46

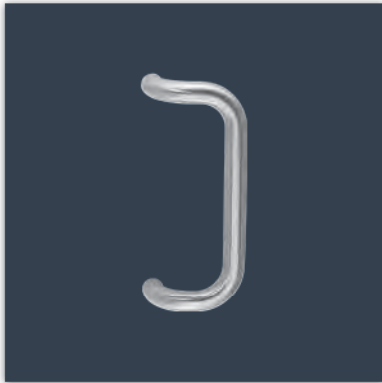
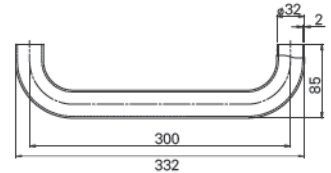

S-410 Push-pull handle cranked

Handle diameter 32 mm. Distance between centres 300 mm. Simple and fast mounting. Single-sided or double-sided fastening possible.

Note: Further centre distances on request.
The accessory for the single-sided fastening has to be ordered separately.



Execution	Single-sided without fixing material	Double-sided incl. fixing material
Article number	255614.46	255624.46

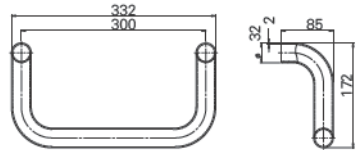

S-210 Push-pull handle triangular

Handle diameter 32 mm. Distance between centres 300 mm. Simple and fast mounting. Single-sided or double-sided fastening possible.

Note: Further centre distances on request.
The accessory for the single-sided fastening has to be ordered separately.



Execution	Single-sided without fixing material	Double-sided incl. fixing material
Article number	255613.46	255623.46

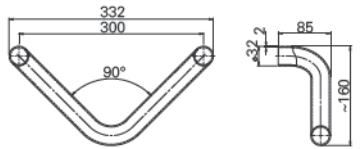

S-510 Push-pull handle semi-circular

Handle diameter 32 mm. Distance between centres 210 mm. Simple and fast mounting. Single-sided or double-sided fastening possible.

Note: Further centre distances on request.
The accessory for the single-sided fastening has to be ordered separately.



Execution	Single-sided without fixing material	Double-sided incl. fixing material
Article number	255612.46	255622.46

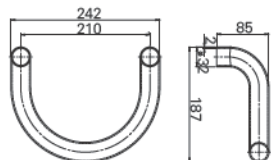

Push-pull handles



S-330 Push-pull handle short

Handle diameter 32 mm. Distance between centres 210 mm. Total length 330 mm.
Simple and fast mounting.
For single-sided fastening.

The fixing set is independent from the door width and has to be ordered separately.

Fixing set for wooden doors: Article number: 10916252
Fixing set for steel and profile frame doors: Article number: 10916251

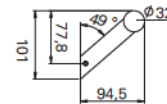
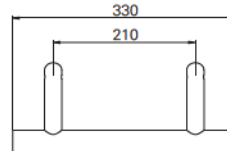

Article number 10255703460080

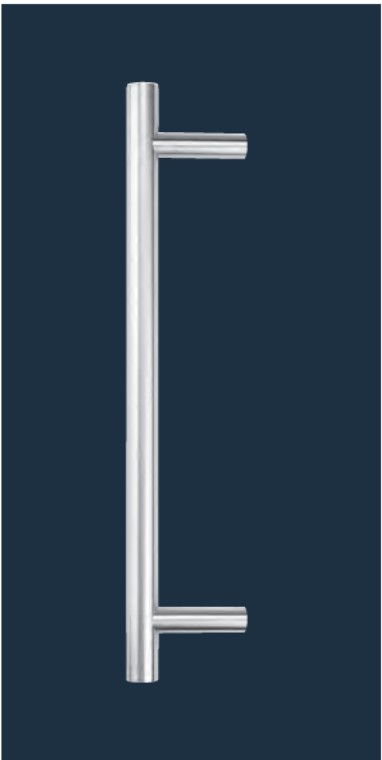

S-310 Push-pull handle long

Handle diameter 32 mm. Distance between centres 600 mm. Total length 1.000 mm.
Simple and fast mounting.
For single-sided fastening.

The fixing set is independent from the door width and has to be ordered separately.

Fixing set for wooden doors: Article number: 10916252
Fixing set for steel and profile frame doors: Article number: 10916251

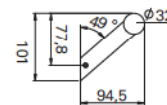
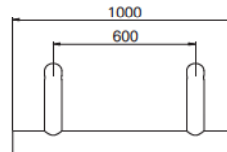

Article number 10255701460080